

How to measure a leading edge

- 1- Lay the bladder flat. Locate the middle by folding it in half and measure it.
- 2- Measure its width at the end and every 2 meters up to the middle. Please fill the tables.
(You can write directly in the pdf document)

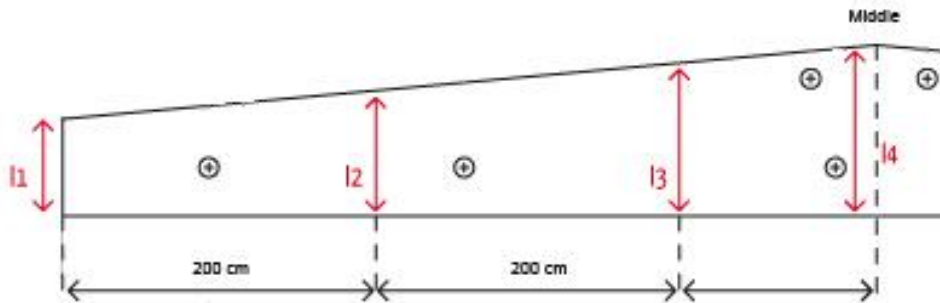

Locate the middle by folding it in half.



Measure the width every 2 meters between the velding.



Dimension		Measure in cm
1	Length of the bladder from the end to the middle.	
2	l1 : width at the end	
3	l2 : width at 200 cm from the end	
4	l3 : width at 400 cm from the end or in the middle if the half bladder is shorter than 400 cm	
5	l4 : width in the middle if the half bladder is longer than 400 cm	

2- Measure the position of all valves from the left end and from the top of the bladder.
Take your measure in the valve axis (center of the valve).

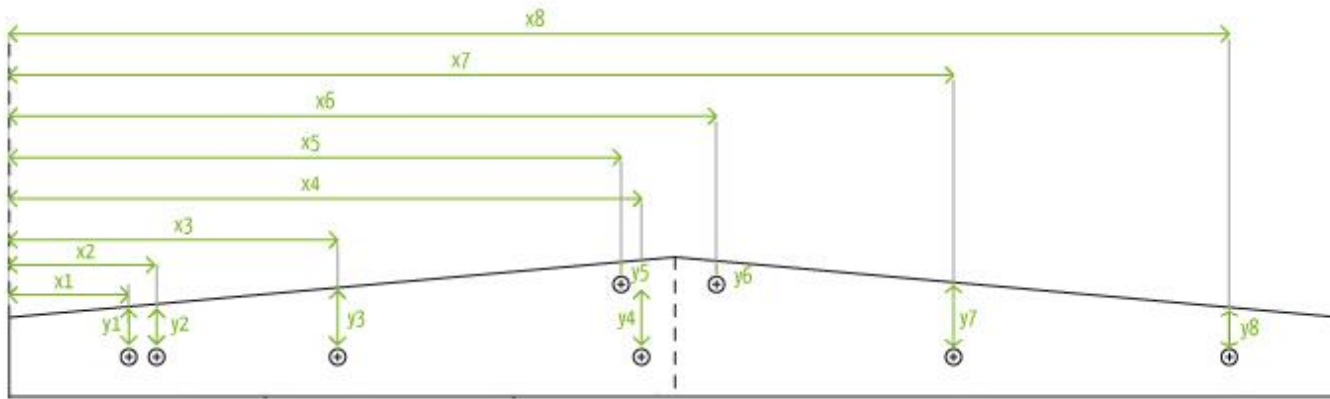

N°valve	Distance from the left end (x)	Distance from the left end (x)	Type of valve (One pump, inflate, etc...)	Position of the tabs or direction of the one pump valves
1				
2				
3				
4				
5				
6				
7				
8				

Indicate on the scheme the position of the valve tabs and the direction of the one pump valves if they are bent.

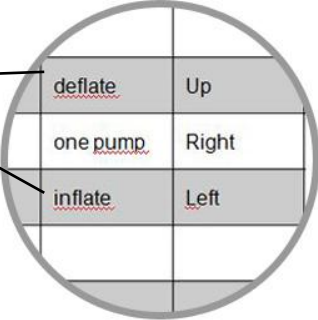

You can also send us a photo of the valves

Send your document by email to contact@wanikou.com or by mail to our address of Leucate: 17, zone artisanale 11370 Leucate. On receipt we will contact you and put the item online so you can order it.